

ETRI®

SPECIFICATION FOR APPROVAL

SPECIFICATION POUR VALIDATION

Customer :
Client :

Description : DC AXIAL FAN
Description :

Part Number : 148DH9TM11207
Référence :

Rev : A
Ind :

*Please send one copy of this specification back after
you signed approval for production pre-arrangement.*

*Veillez nous retourner un exemplaire de cette
spécification pour validation signée, pour le lancement
en fabrication.*

Approved By :
Validé par :

Date :
Date :

Technical Dept. :
Serv. Technique :

ECOFIT  **ETRI** PRODUCTS
Z.I. Sud

Rue Marc SEGUIN - BP 60008

41100 VENDOME - FRANCE

Te1 : +33 (0)2 54 23 14 54

Fax : +33 (0)2 54 72 22 73

site: www.etrinet.com

rosenberg 
THE AIR MOVEMENT GROUP

 **ECOFIT** 

Z.I. Sud

rue Marc SEGUIN - BP 60008

41100 VENDOME - FRANCE

Tél : 33 (0)2 54 23 14 54

Fax : 33 (0)2 54 72 22 73

PART NUMBER 148DH9TM11207 Ind.A

ELECTRICAL SPECS

Nominal voltage110 volts
Voltage range(76-140)V
Frequency
Phase= DC

DESCRIPTION

Fanhelicoid
Motor typeDIRECT CURRENT
ClassB
IPIP20
Dielectric1500vef50Hz/1mn
Dimensions (mm)Length 172,00 width: 150,00
Thickness: 38,00 :
weight0,77 Kg
Earth/GroundØ 3,85 (pour vis M4 ou 8.32 UNC Taptite)
Housing materialZamak
Fixing holesØ4,5 bNbr 2 + boss
Impeller materialPlastic UL 94 V0
Type of bearings Ball Bearing
Drawing/Performances curves /

(1) = (enclosure)

ENVIRONMENT

Design Code C14+BS	: Special T °+ Salt Spray Pro.
Operating tempMin:	-25°C Max: + 70 °C
Storage temperature	-50 à +85°C
Life time (typical value)	80.000 Hours at 40°C L10

Connection
 Terminals
 FASTONS 2,8x0.5

APPROVAL
 CE RoHS UL

PART NUMBER 148DH9TM11207 Ind. A

DIVERS

Motor protection	Circuit Intégré			
Variable Speed-input				
Speed Sensor	" NO "		* VCC =	
Qty cycles per road= 02	Vce(sat)=	* Ic=	* R:>= Kohms	
output collector	* Fil(s) *	* AWG	*	*
T0 =	* T1 =	* T2 =	* T3 =	
Sensing Temperature	NO			

SALT SPRAY :
NF.C 20711. Essai Ka (96 heures).

SHOCKS :
NF.C 20727. Essai Ea-30A (hors fonctionnement)
CEI 61373 - Cat. 1 / Class B.

VIBRATIONS :
NF.C 20706. Essai Fc Tableau III (10-55). Amp. 0,35 mm ou 5 gn.
CEI 61373 - Cat. 1 / Class B.

DAMP HEAT :
NF.C 20703. Essai Ca (21 jours à 95 % HR à 40°C).

Performances of PART NUMBER 148DH9TM11207 Ind. A

			According to CCTU 18-10					*	Performances at free air					
Volts	Frequency	Phase	Static Pressure			Airflow		Noise	Speed	Power	Intensity		Capacity	Rise
(V)	(Hz)	(s)	(mm H2O)	(inch)	(Pascal)	(l/s)	(cfm)	Lp	(Rpm)	Watts	nom.(mA)	strt(mA)	start	Wind.
			(μF)/Volts	(°C)										
110	sans	sans	12	0,47	117,72	112	237,29	58,00	3100	13,4	122	330	/	

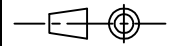

TERMINAL

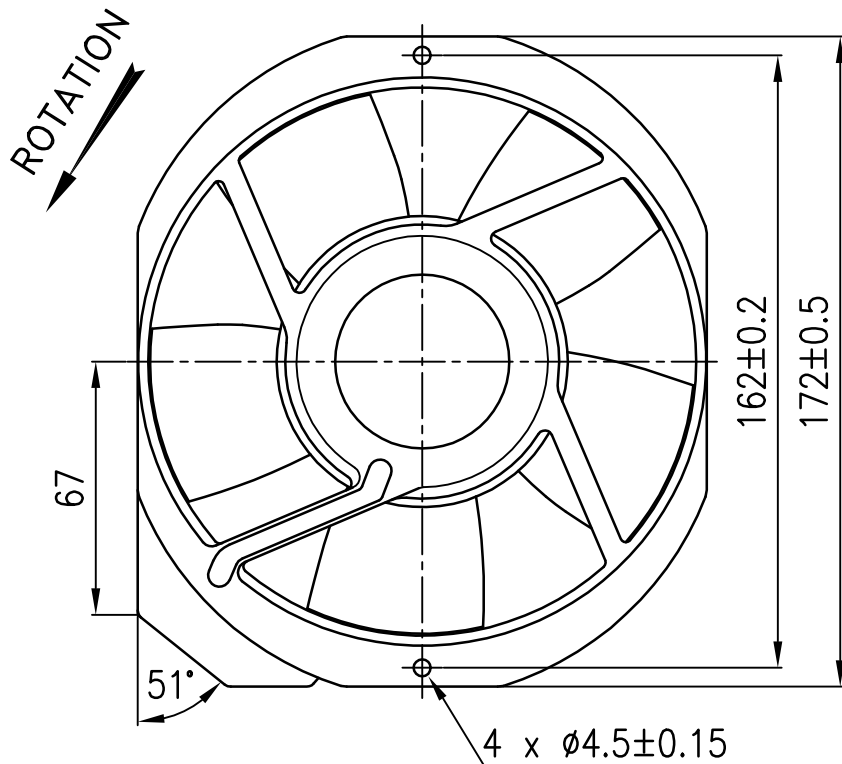
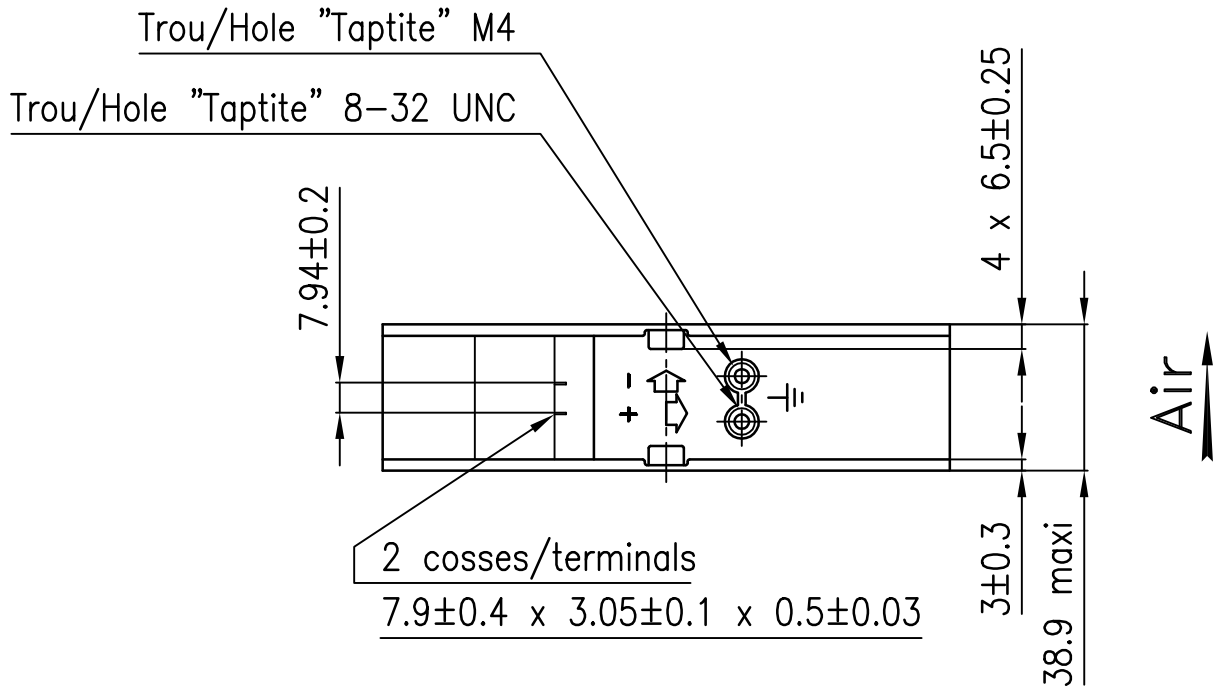

OPTION: SORTIE/OUTPUT FILS/WIRES

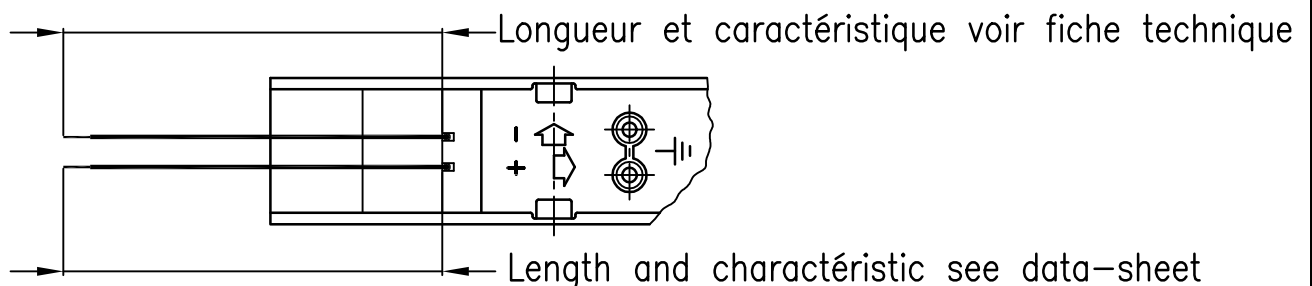



FICHE TECHNIQUE
VENTILATEUR
FAN DATA-SHEET

DC
110V

n°FT: 2301534010
MODELE: 148DH9TM11207
TYPE: 172 x 150 x 38

1/1

DATE
27/10/97

Ind.
/

COURBE AERAULIQUE - PERFORMANCES CURVE

